



CARBURETOR & PARTS

CARB FOR ANCIENT 2CV

		euros incl. VAT
New Old Stock Solex 26 OEM carburetor (Limited Stock)	D5511	150.00
New 28 carburetor repro	D5513	175.00
Solex 26 & 28 BCI/CBI Gasket Set	D5530	6.95
Idem Gaskets + Throttle Shaft Seals + Needle Valve	D5531	15.90
Base Gasket only 26 & 28	D5228	0.40

34 CARB

A New 34 Carburetor repro	D5510	160.00
Base Gasket 34	D5512	1.30
Repair Kit		
solex 34 including the jets (nozzles)	D5541	21.00
B solex 34 including the jets, shaft, float, throttle, etc... super complete	D5542	37.00
C New Air Filter casing repro	D5508	75.00
D Base Spacer	D5514	9.00

40 CARB

Repair Kit solex 40 PCIS Ami 6 & Dyane	D5545	18.90
--	-------	-------

DUAL BARREL CARB 26/35

E Remanufactured Carb (+core 90.00 euros)	D5505	330.00
Repair Kit		
F dual barrel 26/35 without jets	D5550	17.90
! super complete with jets	D5551	39.65
G Base Gasket	D5547	1.95
H Top Gasket	D5548	3.90
I Accelerator Cable	D5880	15.90
J Accelerator Pump OEM new	D5553	118.00
K Spacer	D5554	9.90
L Choke Return Spring	D5515	1.50

CARBS : ALL MODELS

M Throttle Shaft Spring	D5516	1.50
N Throttle Shaft Seal	D5546	3.90

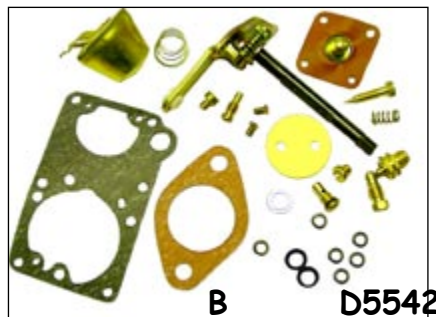
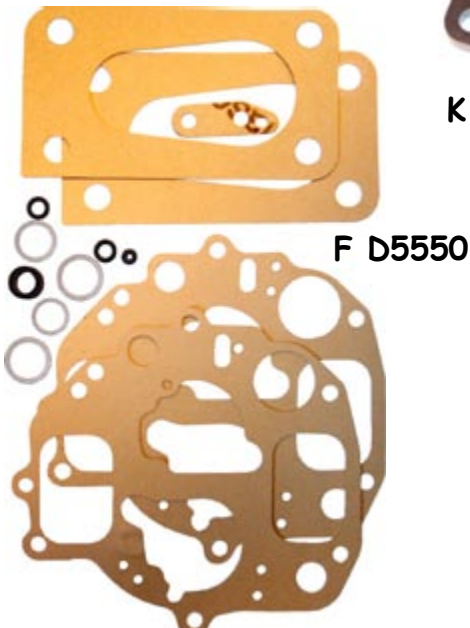
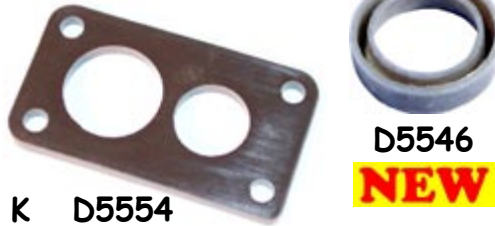
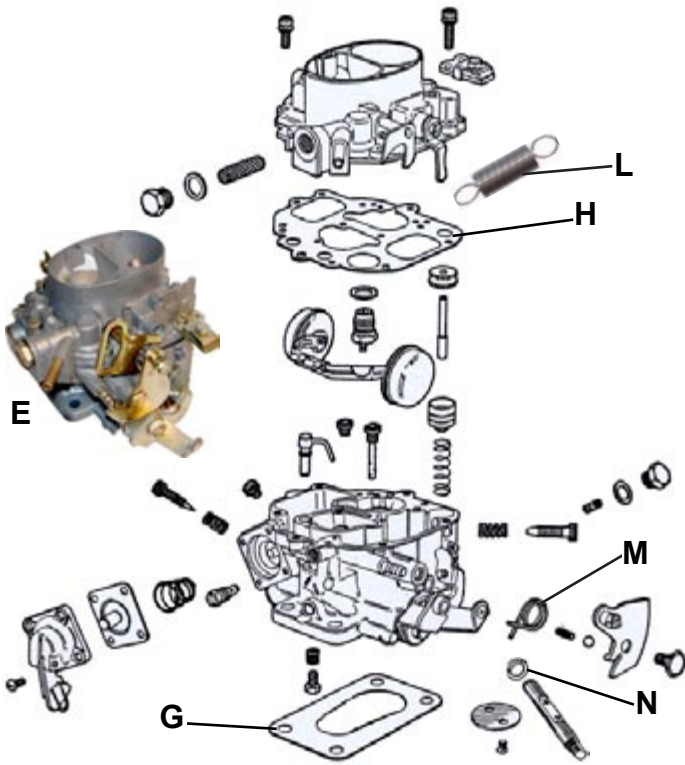

BAISSE DU PRIX !



NEW



NEW



NEW

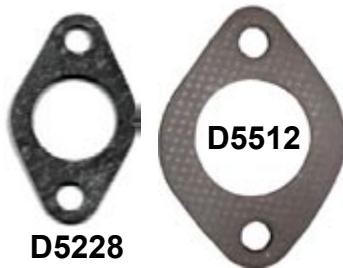

NEW

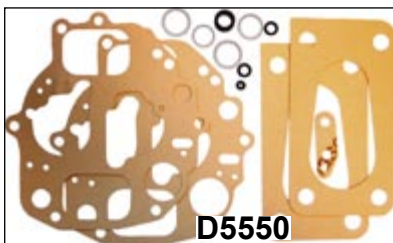

NEW



D5547



D5516

NEW



PAGE 23 bis